



UPS Series

IBT'S UPS Series Valve Regulated Lead Acid batteries are designed with AGM (Absorbent Glass Mat) technology, high performance plates and electrolyte to gain extra power output for common power backup system applications. Widely used in the field of UPS, Emergency Lighting System.

Application

- UPS
- Communication Equipment
- Security System
- Cable Television
- Control Equipment
- Medical Equipment
- Emergency Power System
- Power Plant

General Features

- Extra long life service design (up to 20 years) for 2V models.
- Non-Spillable construction design.
- ABS containers and covers(UL94HB, UL94V-0) optional.
- Safety valve installation for explosion proof.
- Higher safety & reliable construction.
- Exceptional deep discharge recovery performance.
- Low self discharge characteristic.
- Flexibility design for multiple install positions.

Construction

- ComponentRaw material
- PositiveLead dioxide
- NegativeLead
- ContainerABS
- CoverABS
- SealantEpoxy Resin
- Safety valveEPDR
- TerminalCopper
- SeparatorFiber glass
- ElectrolyteSulfuric acid

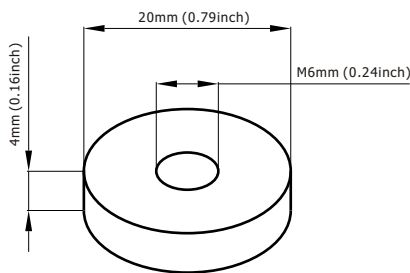

Terminal Dimensions

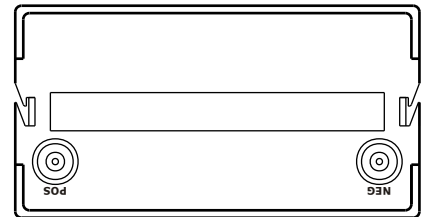
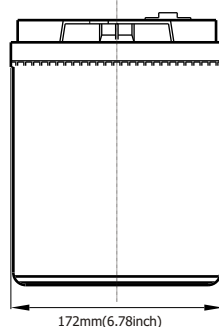
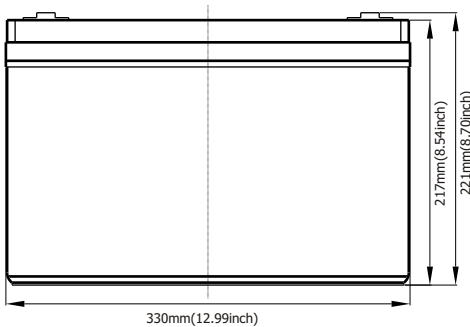

Battery Model	HP12-100 (390W/cell to 1.67V,15min)			
Designed Floating Life	8 Years			
Capacity(25°C)	20HR(5.8A,1.75V)	10HR(11A,1.75V)	5HR(18.7A,1.75V)	1HR(66A,1.75V)
	116AH	110AH	93.5AH	66AH
Dimensions	Length	Width	Height	Total Height
	330mm(12.99inch)	172mm(6.77inch)	217mm(8.54inch)	221mm(8.70inch)
Approx. Weight	31.6Kg (69.65lbs)			
Internal Resistance	Full charged at 25°C: 0.0053 Ω			
Self Discharge	3% of capacity declined per month at (25°C)			
Capacity Affected by Temp.(20HR)	40°C	25°C	0°C	-15°C
	102%	100%	85%	65%
Charge Voltage(25°C)	Cycle use		Float use	
	14.4-15V(-30mV/ °C), max. Current: 25A		13.6-13.8V(-20mV/ °C)	

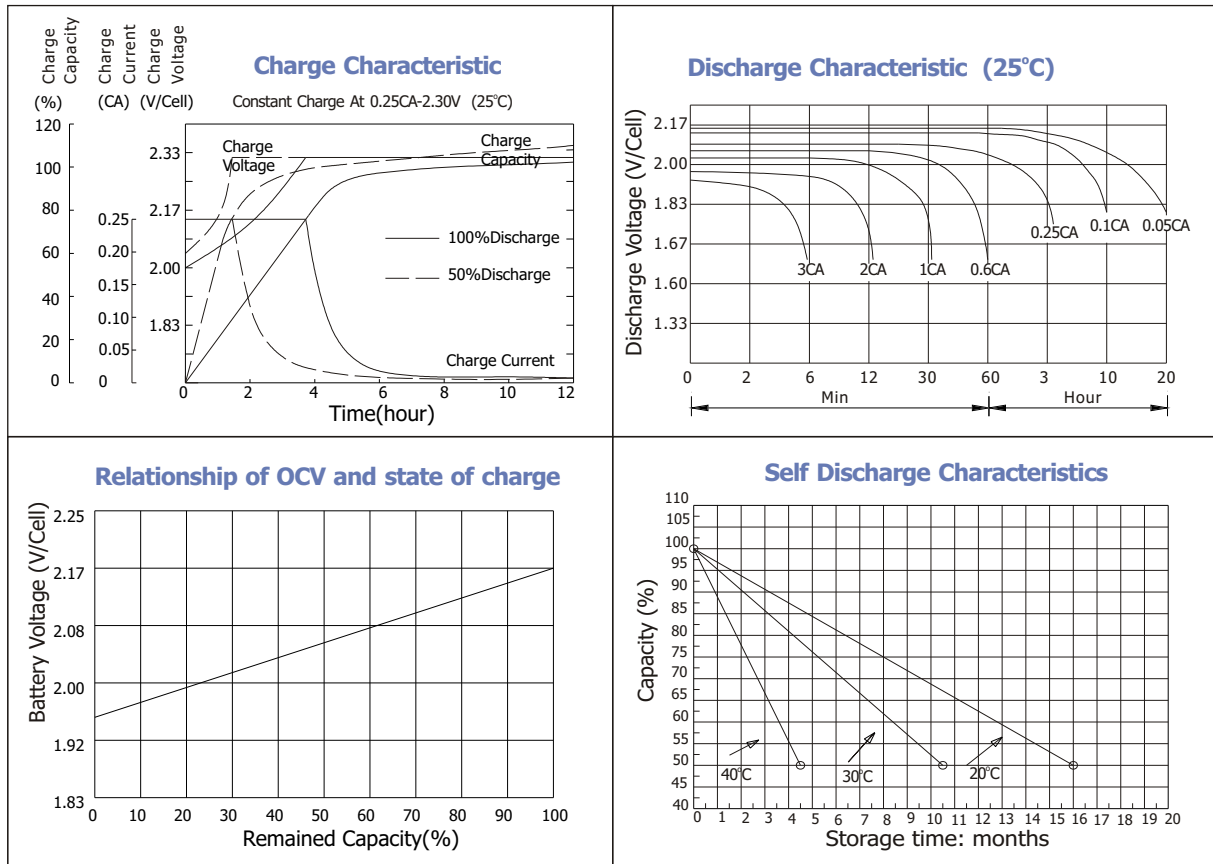

Constant current discharge ratings-amperes at 25°C - (Valores medios después de 5 ciclos)

F.V/Time	5MIN	10MIN	15MIN	30MIN	1H	3H	5H	10H	20H
1.60V	461	287	216	132	72.7	32.0	20.0	11.3	6.17
1.67V	433	272	208	126	71.8	30.7	19.5	11.2	6.05
1.70V	396	262	203	115	69.5	28.5	19.1	11.1	5.95
1.75V	389	254	197	109	66.0	27.5	18.7	11.0	5.80
1.80V	348	243	179	101	61.4	26.3	17.5	10.8	5.70
1.85V	307	231	161	92.9	55.9	25.3	17.1	10.7	5.60

Constant power discharge ratings-watts at 25°C - (Valores medios después de 5 ciclos)

F.V/Time	5MIN	10MIN	15MIN	30MIN	1H	3H	5H	10H	20H
1.60V	809	518	395	238	131	56.7	33.6	23.0	12.3
1.67V	780	505	390	233	130	54.8	33.5	22.8	12.1
1.70V	735	500	387	218	128	52.1	33.0	22.1	11.9
1.75V	739	498	383	211	125	50.8	32.7	22.4	11.7
1.80V	676	491	356	202	117	49.2	31.7	22.1	11.5
1.85V	614	466	322	189	110	47.6	30.6	21.8	11.3

